

Direct Tension Indicator Guide

May 2020



Testing

Step 1

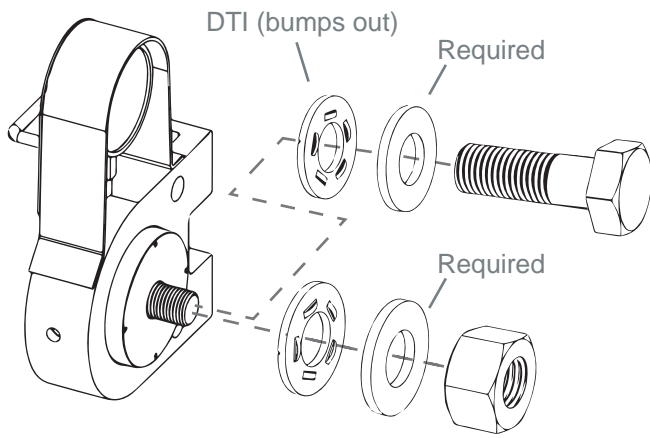

Assemble hardware in a tension calibrator.

Step 2

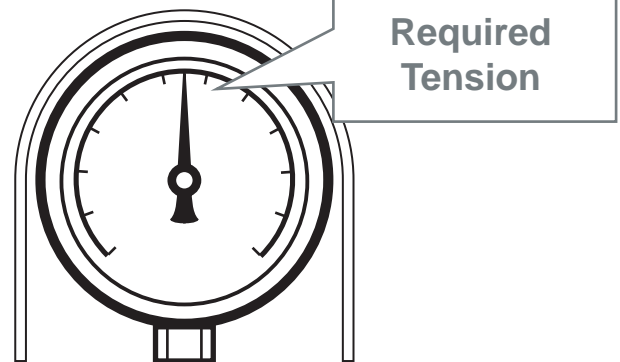

Tighten hardware to the required tension.

Step 3

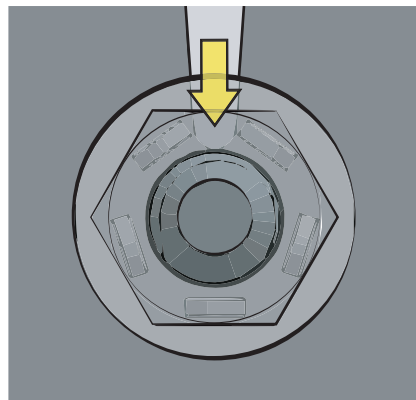
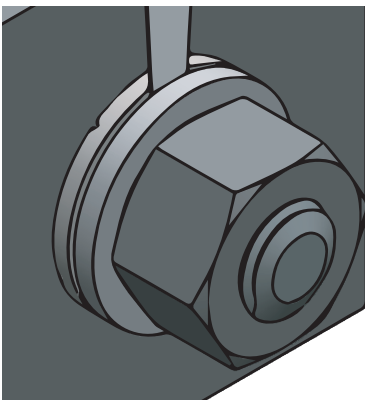

Completely flat is a problem when testing but not in the steelwork.

Record the results from testing to form the job inspection gap.

Measure the gap at this test tension; to which you will make smaller in the steelwork.

Direct Tension Indicator Installation and Inspection

Assemble

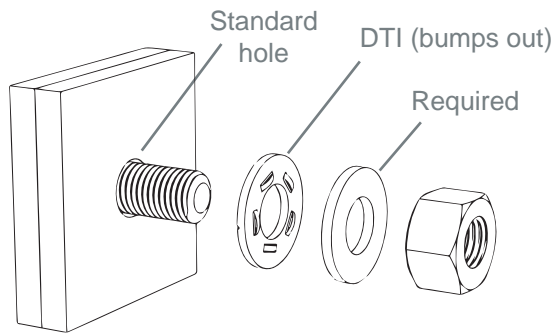

Recommended

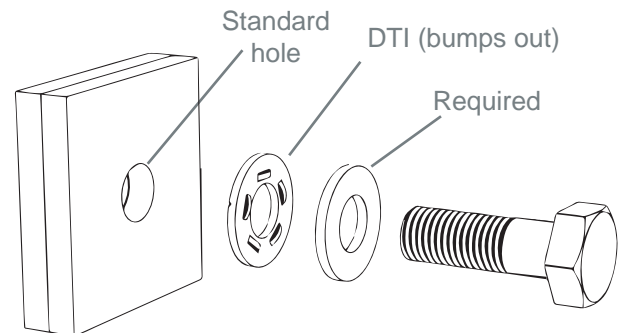

Alternative

Snug

Bring the steelwork together before completely flattening the DTI.

Standard DTI

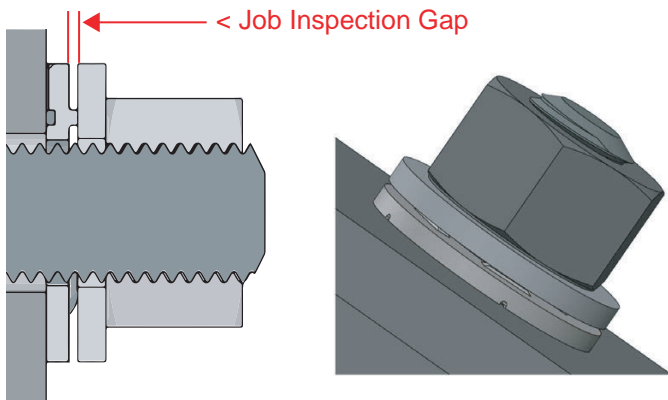

Tighten until the gap is gone, or smaller than the job inspection gap.

Squirter® DTI

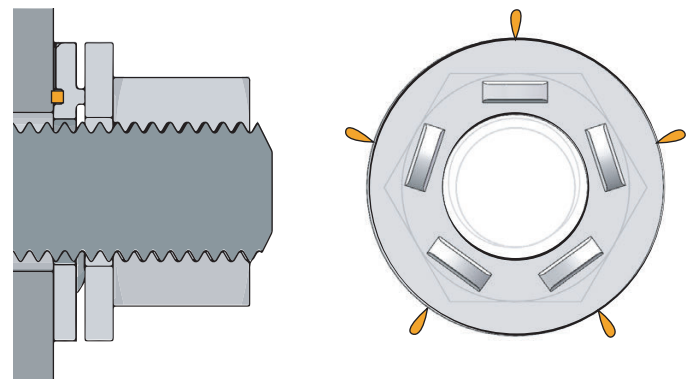

Tighten until orange is visible at all bump locations. The job inspection gap may be confirmed if the indication media is gone.

Inspect

Squirter® DTIs enable complete visual inspection. Otherwise, ensure enough DTIs are flatter than the job inspection gap or are completely flat.

If it's not easy call us! We want you hanging iron.

(802) 460-3100 or **appliedbolting.com**

Check the website for bolting resources; Including test forms.

Videos, and Tips



Scan for support